

Median removal at Yonge Street and John Street

Expected start: Early May 2026

Duration: Approximately two weeks

Timing: Weekdays from 7 a.m. to 5 p.m. Occasional weekend or overnight work, as required.

Map of work area:

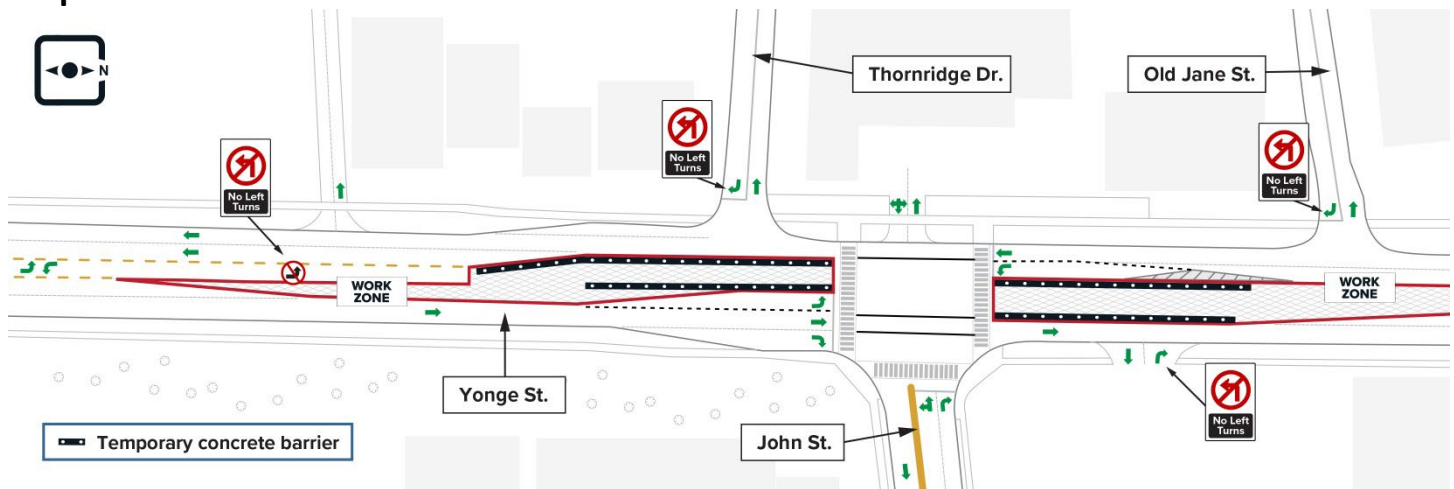

Figure 1: The approximate work zone. Map is not to scale and solely for illustrative purposes.

What is happening?

Crews working on behalf of Metrolinx will be performing preliminary work starting with median removal to prepare for the construction of a vertical shaft that will support excavation for the future emergency exit building (EEB4) on Yonge Street south of John Street. An emergency exit building is a small, permanent surface structure that provides a safe evacuation route for subway passengers or workers and an access route for first responders in case of an emergency.

About the Yonge North Subway Extension

The Yonge North Subway Extension will transform the commute in York Region, Toronto and beyond by extending the TTC's Line 1 service north from Finch Station to Vaughan, Markham and Richmond Hill. The project includes five new stations along an extension of approximately eight kilometres.

WORK DETAILS:

- Work will include removing the centre medians at the intersection of Yonge Street and John Street, relocating utilities and installing temporary traffic signals, and widening the road.

WHAT TO EXPECT:

- Residents can expect to hear noise from heavy construction and demolition equipment such as excavators, jack hammers, dump trucks, and concrete saws.
- Water sprays and biodegradable dust suppressants will be used to reduce dust created by construction activities.
- Noise, vibration and air quality levels will be continuously monitored and measured.
- Measures will be taken to minimize disruptions to the surrounding community wherever possible.

TRAFFIC CHANGES:

- Traffic will be reduced to one lane northbound and one lane southbound through the construction zone.
- Access to Thornbridge Drive, Old Jane Street and the Scotiabank driveway will be right in right out only.
- Left turns into the driveway at 7620 Yonge Street will be prohibited.

PEDESTRIAN ACCESS:

- No impacts.

HAVE A QUESTION OR CONCERN?

WE'RE HERE FOR YOU.

- We have a dedicated team ready to answer any questions you may have about the Yonge North Subway Extension and the work happening in your community.
- For the most up-to-date project information, and to share your feedback, please reach out to us. See our contact details below.

CONSTRUCTION TIMELINE

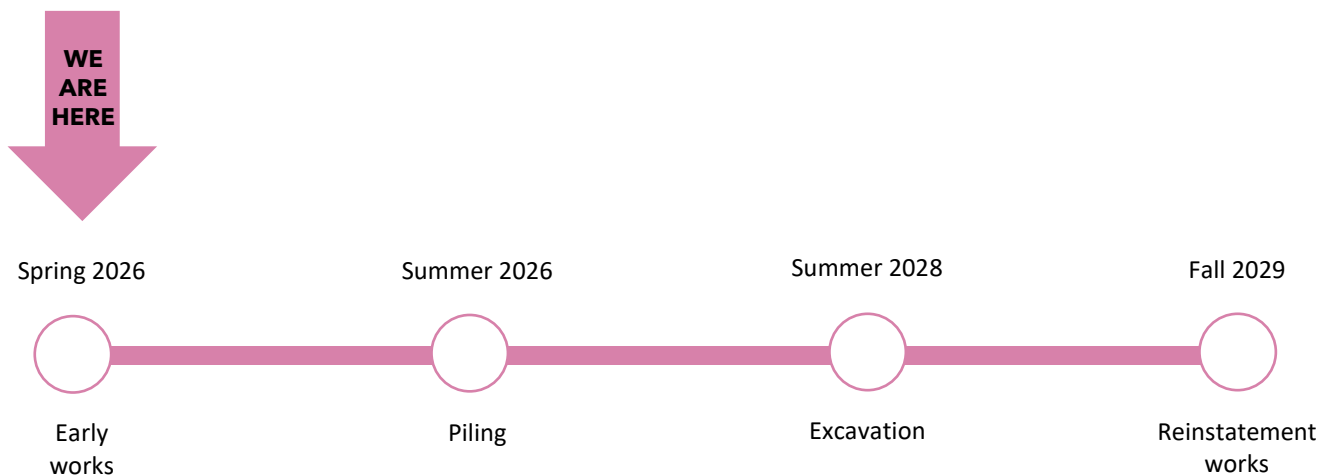

Figure 2: The approximate timeline for construction of the vertical shaft support structure for EEB4. Timing subject to change. Advance notice will be provided where possible.

Still have questions? Ask us!

✉ Write to us at: YongeSubwayExt@metrolinx.com

📍 Visit us at: 295 High Tech Road, Unit 4, Richmond Hill, ON L4B 0A3

☎ Call us at: 416-202-7000

🌐 Visit the website: www.metrolinx.com/YongeSubwayExt

Disponible en français sur demande. Si vous êtes intéressé, veuillez envoyer un courriel à YongeSubwayExt@metrolinx.com.